

# SARA ON BASE

17-May-2019

## 1.0 PAR16

PAR16 max. 12W | GU10 | 100-240VAC | 50-60Hz

CE IP20 0.9m 90°

white texture  
black texture  
gold

157220W0  
157220B0  
157220G0

### OPTIONAL

for PAR16 lamps see our catalogue

base plate dimensions

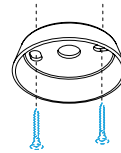
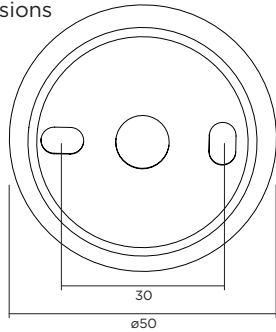

① ↑

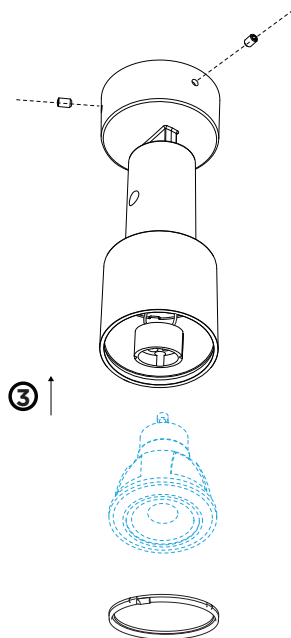

③ ↑

## DIMENSIONS

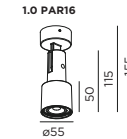

## MOUNTING INSTRUCTION

- ① Remove the screws, put the cables through the opening and mount the base on the ceiling.

## POWER CONNECTION

- ② Interior: connection: STANDARD version

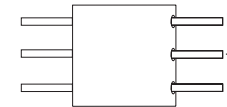

Mount the fixture again with the screws on the base.

- ③ For PAR16: mount the lamp.



WEVER & DUCRÉ  
LIGHTING

[www.weverducre.com](http://www.weverducre.com)

Wever & Ducre bvba Spinnerijstraat 99/21 8500 Kortrijk

INSTALLATION  
INSTRUCTIONS