

INSTRUCTION MANUAL

PC

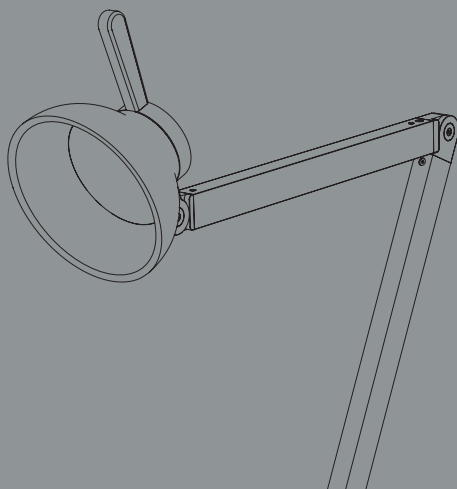

By Pierre Charpin

HAY

INTRODUCTION

Pierre Charpin's PC Task Lights series is a collection of refined and precisely engineered task lamps designed to provide focused light where needed. The lamps are constructed in aluminium, with a subtle sheen finish. The functional design conceals gas springs that enable the arms and head to hold their position wherever they are moved and features an integrated touch dimmer switch with a memory function that provides control over the level of brightness and automatically turns off after five hours. The PC Task Lights are available in a variety of size and colour options and are suitable for both contract and domestic markets.

TECHNICAL DATA

This product is supplied with an integrated LED module (3000k warm white, 360 lumen). The expected lifespan of the LED module is 25,000 hours. When the light source

reaches its end of life, the whole luminaire should be replaced.

ATTENTION

In some countries, electrical installations must be carried out by authorised electricians/contractors; please check with your local authority for guidance. HAY accepts no

responsibility for any products that have been modified or tampered with.

CARE AND MAINTENANCE

The product can be cleaned with a soft damp cloth and mild detergent. Do not use alcohol or any other solvents to clean the product. The external flexible cable or cord of this luminaire cannot be replaced; if the cord is

damaged, the luminaire should be destroyed. Ensure that the power supply has been turned OFF before cleaning the product.



PARTS

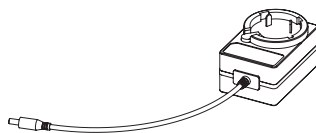
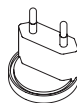
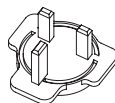
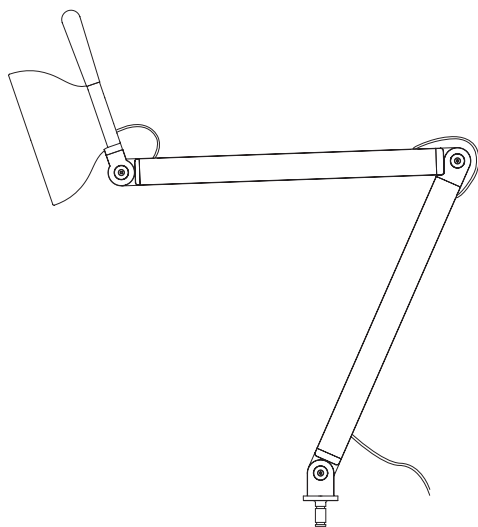

The lamp can be used with several different bases and fixings.

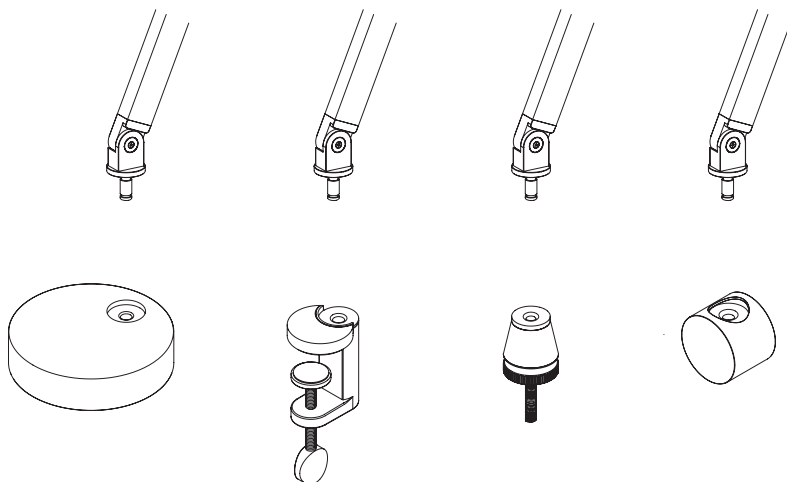

1.

Table Lamp only

Unpack the lamp and insert it into the base (packed separately). Using the provided tool and screw, the lamp can be fixed to the base through a hole underneath.

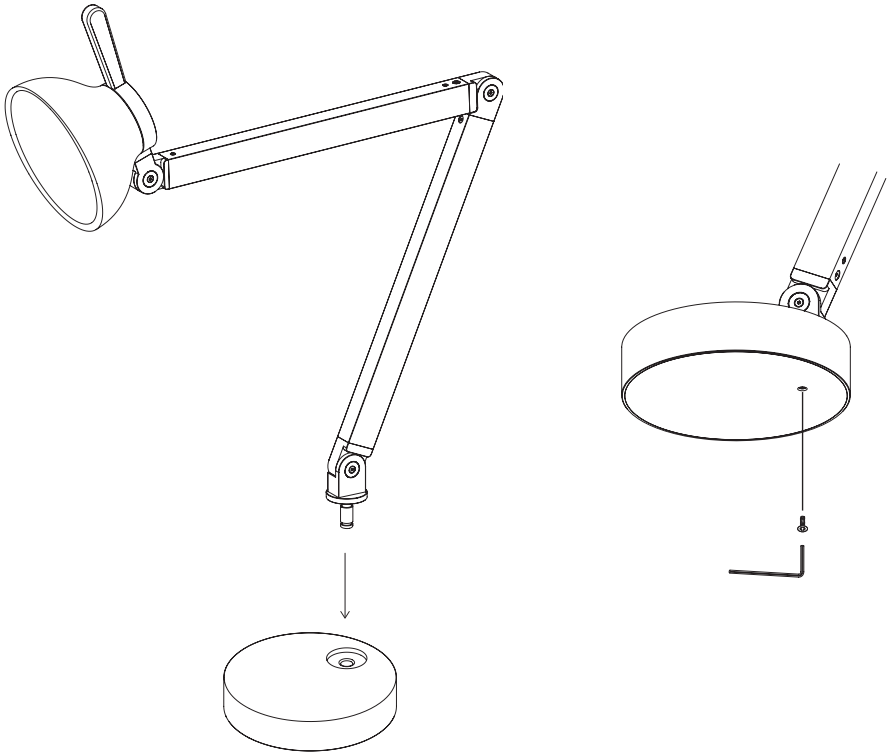

2.

Clamp only

Clamp the clamp base in place by adjusting the grip.

Insert the lamp body into the clamp base.

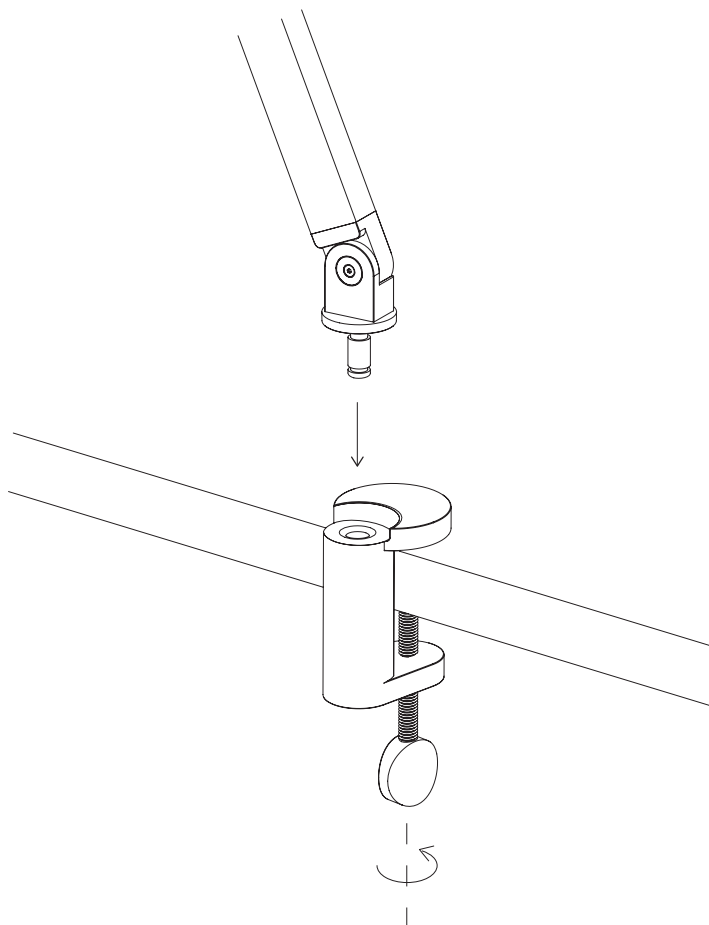

3.

Table Insert only

Carefully drill a 10 mm hole into a desktop where you would like the lamp to be positioned. Insert the table insert into the hole and tighten the circular nut underneath to hold firmly in place.

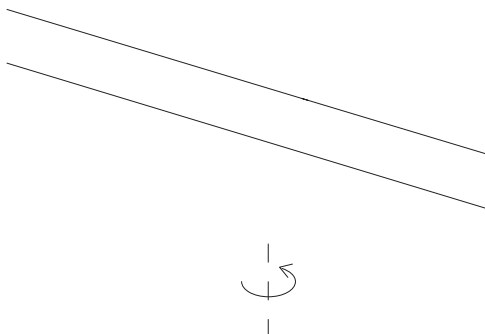
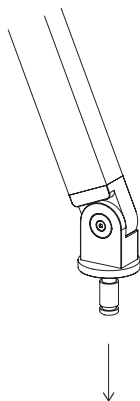
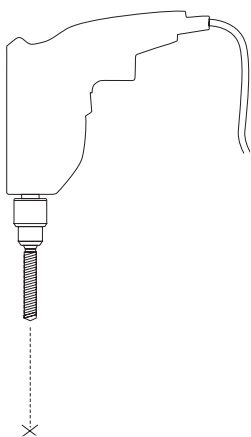

4.

Wall Bracket only

With a pencil, mark fixing holes on the wall.

Drill holes and insert wall plugs. Ensure you use the correct type of wall plug for the material you are drilling into.

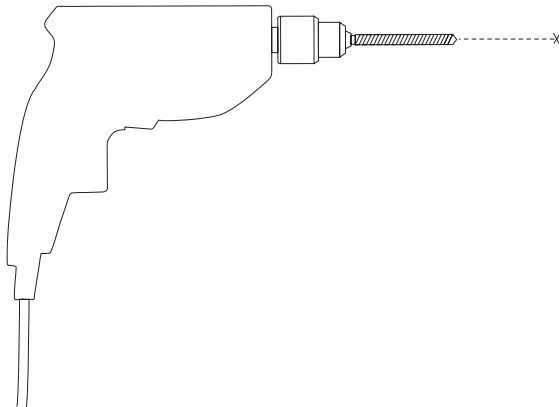
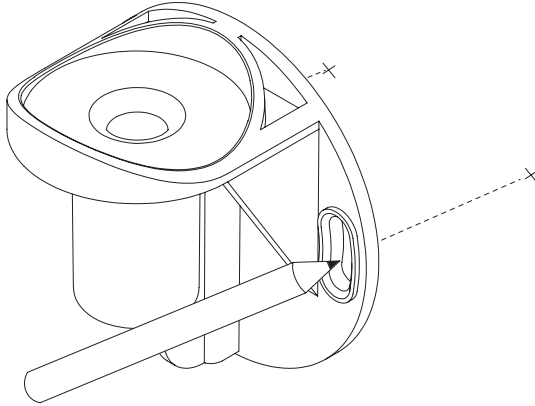

5.

Wall Bracket only

Screw the internal bracket to the wall with the fixings provided and place the external plastic cover over the wall bracket.

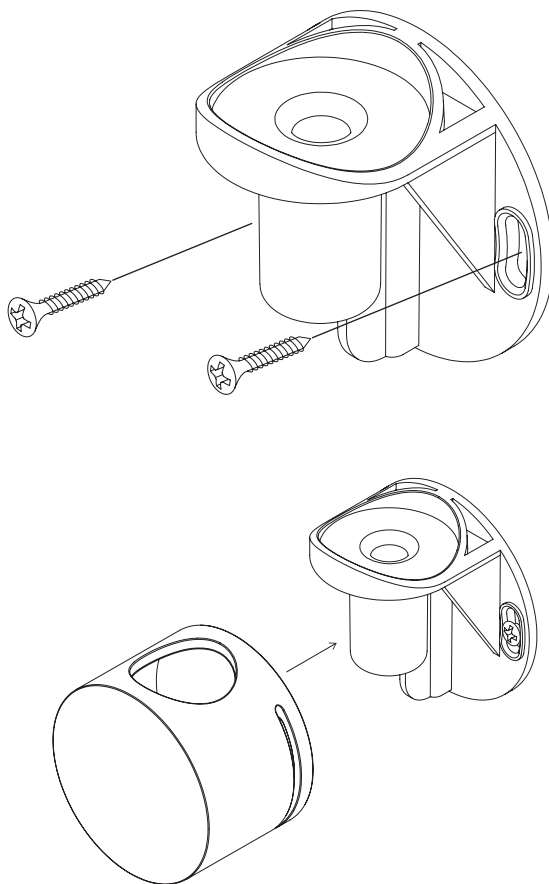

6.

Wall Bracket only

Fix the external plastic cover in place with the provided screw.

The groove on the side of the plastic cover provides simple cable management for the wall mounted lamp.

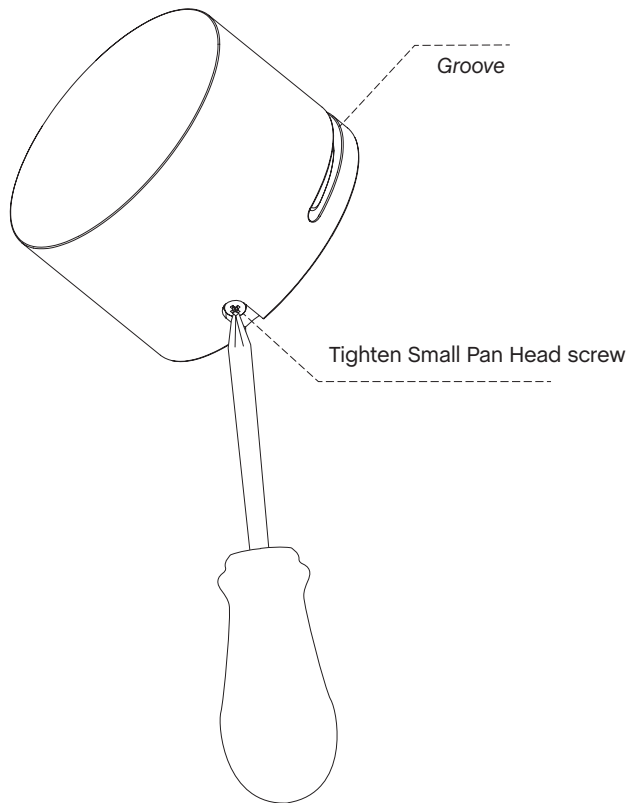

7.

Wall Bracket only

Insert lamp into the wall bracket and push the cable into the groove.

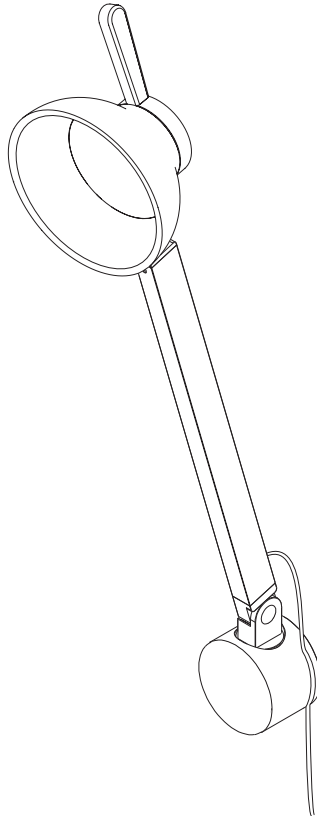

8.

The lamp can be freely moved and will hold in any position.

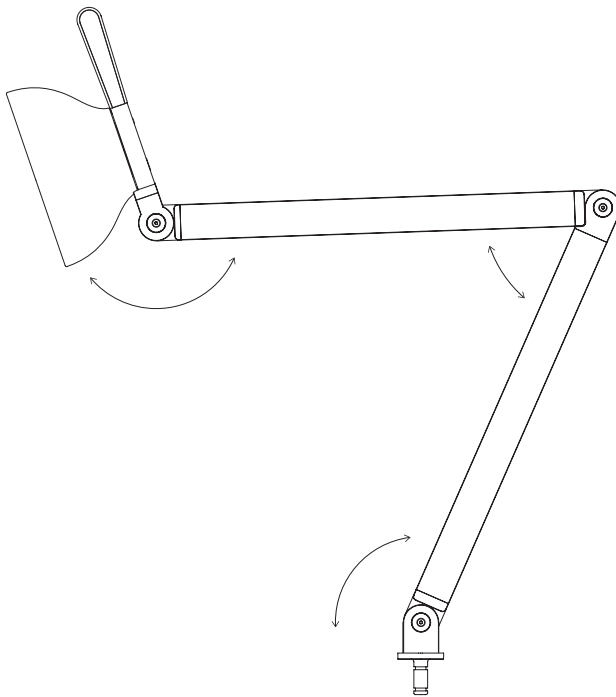

9.

If necessary, the joints can be adjusted using the provided torx tool.
Carefully tighten the bolts until the lamp supports itself in any position.

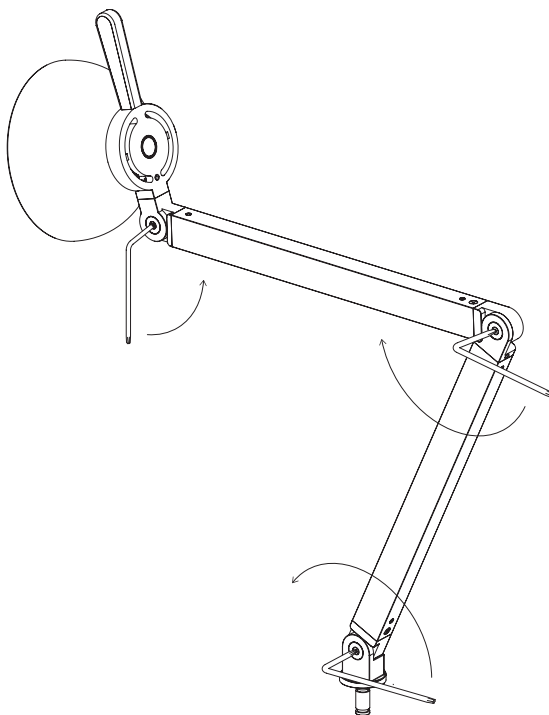

10.

Plug the trailing cable into the power supply.

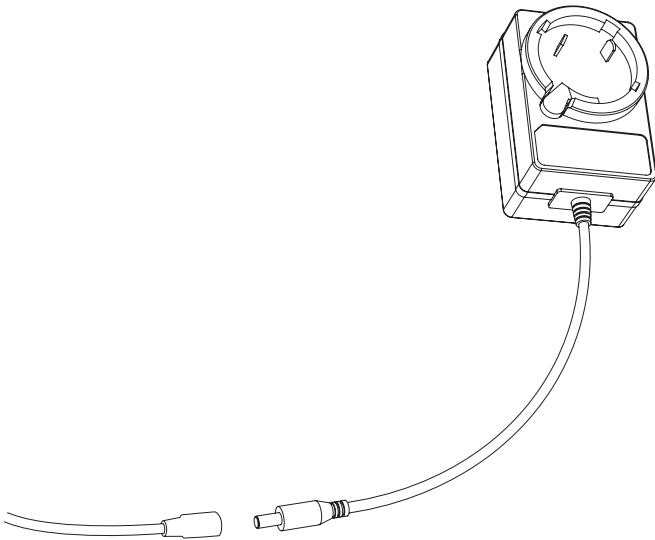

11.

Attach the correct adapter for your region.

The lamp is now ready for use.

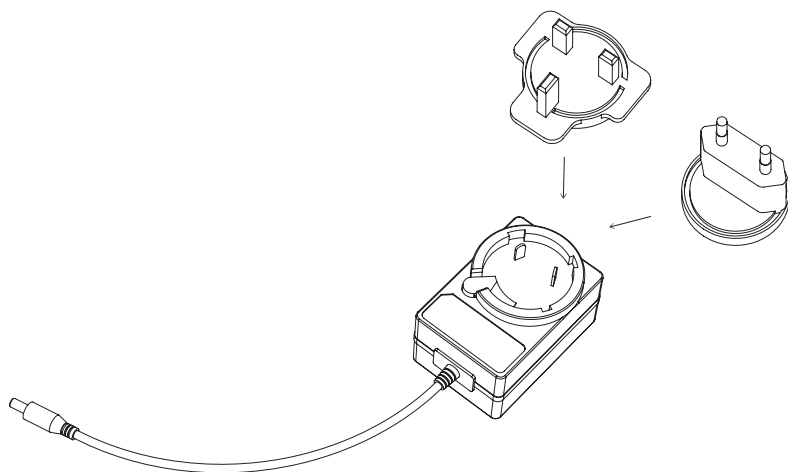

Havnen 1 8700 Horsens Denmark
+45 4282 0282 / hay@hay.dk

HAY