

MIRBI LONG IP44

INSTALLATION INSTRUCTIONS | APRIL 2023

Necessary for IP-rating

	A	B	C
CABLE			
TYPE	ROUND H05RN-F H07RN8-F H07RN-F	ROUND H05RN-F	ROUND
OUTSIDE Ø	min 6.8mm max 8.9mm	min 5mm max 6.8mm	min 1.5mm max 2.6mm
CONDUCTION SECTION	2or3x 0.75mm ² 2or3x 1.0mm ² 2or3x 1.5mm ²	2or3x 0.75mm ² 2x 1.0mm ²	0.75mm ² 1.5mm ²

Mounting base:

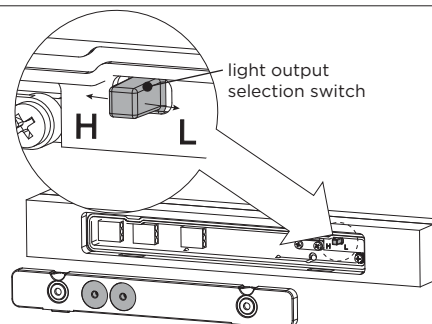
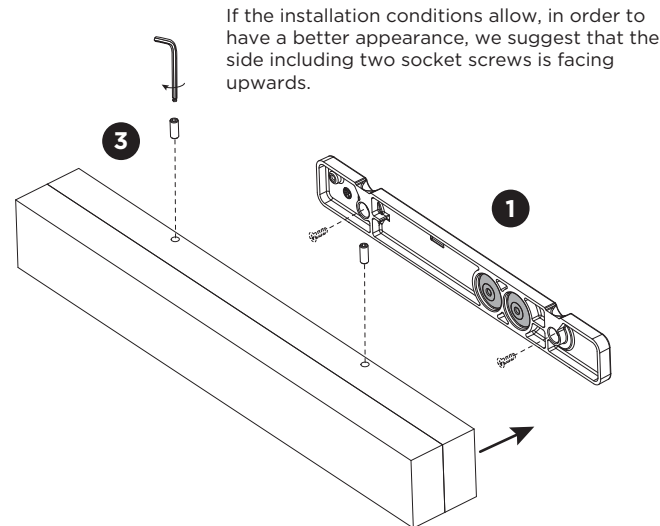
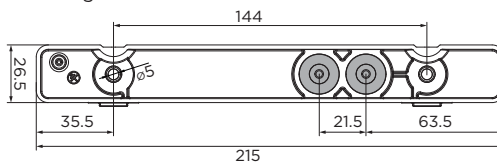

Product must be powered off before switching the output.

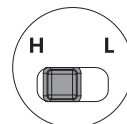

High light output

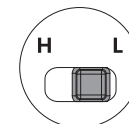

Low light output

DIMENSIONS

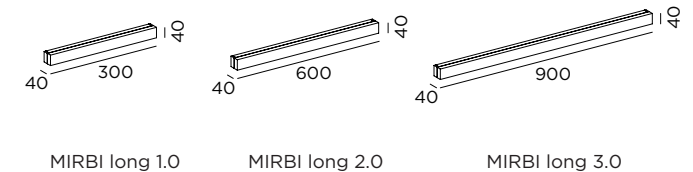

MOUNTING INSTRUCTION

- 1 Remove the mounting base from the luminaire by loosening the socket screws and mount it on the wall with screws (screws are not included).

- 2 **POWER CONNECTION**
Connect to 220-240V.

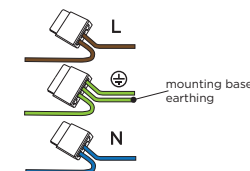

Connect to the earth cable



- 3 Fix the luminaire on the base with 2 socket screws.

MIRBI LONG IP44

INSTALLATION INSTRUCTIONS | APRIL 2023

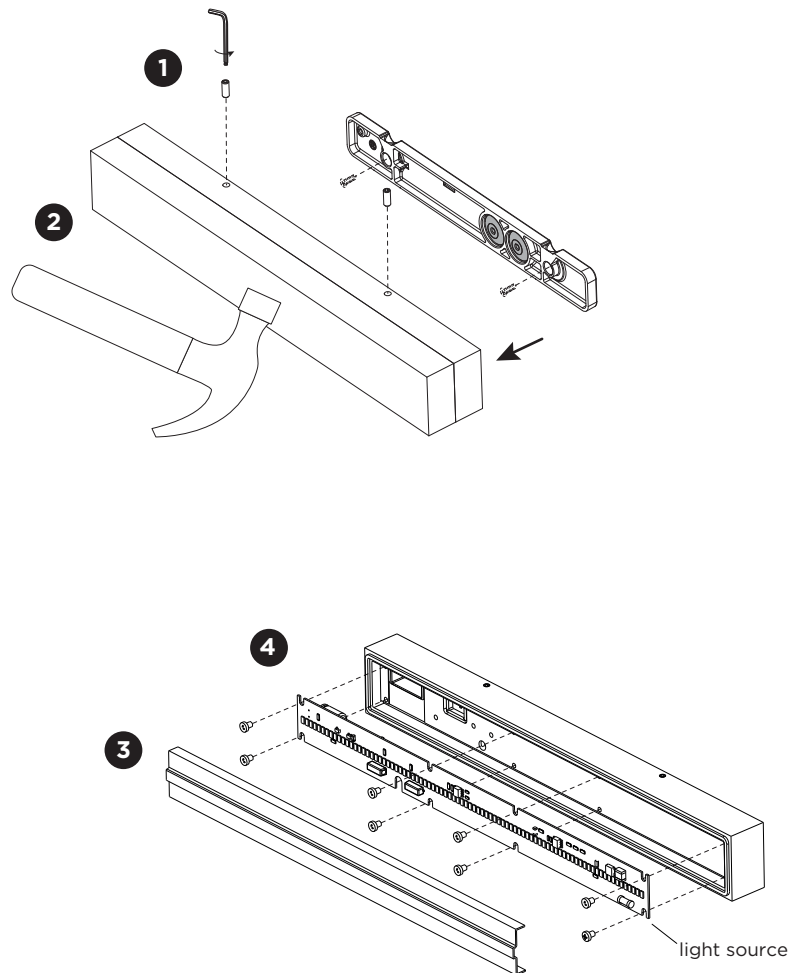

DISMOUNTING AND RECYCLING INSTRUCTIONS

Light source

- 1** Remove the fixture from the mounting base by removing the socket screws.
- 2** Break the glass.
- 3** Take off the cover.
- 4** Unscrew the light source and disconnect the wires to remove the light source.

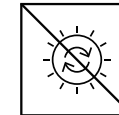

The light source is not replaceable.



This luminaire contains a light source with the energy class F.