

LUNA HV (ROUND / SQUARE)

INSTALLATION INSTRUCTIONS | NOVEMBER 2022

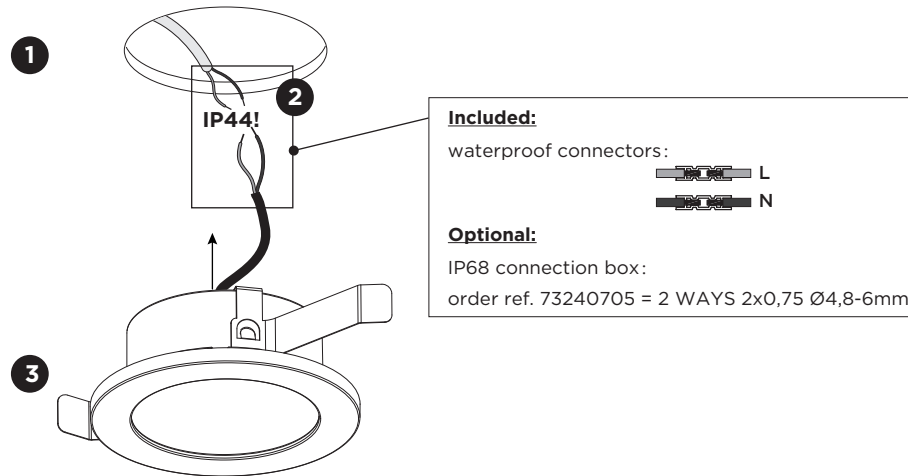

DIMENSIONS

1.0 LED HV
ROUND

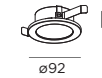

76-79

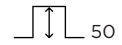

1.0 LED HV
SQUARE

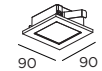

72-72

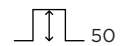

MOUNTING INSTRUCTION

- 1** Make a hole in the ceiling according to the prescribed dimensions.
- 2 POWER CONNECTION**
Connect to 220-240V.
Please see the detail method in the separate instruction sheet of waterproof connection. Make sure to use a waterproof connection with the same IP rating as the luminaire.
- 3** Push the springs towards the luminaire and insert the fixture in the hole.

LUNA HV (ROUND / SQUARE)

INSTALLATION INSTRUCTIONS | NOVEMBER 2022

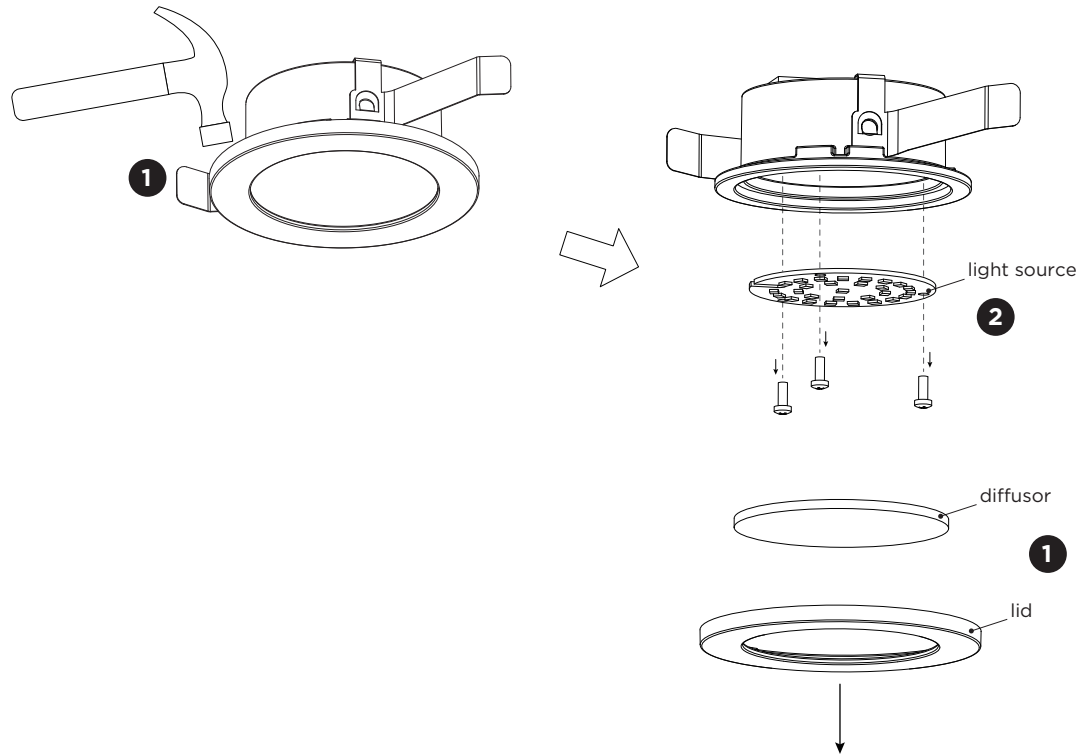

DISMOUNTING AND RECYCLING INSTRUCTIONS

Light source

- 1 Forced remove the lid and diffusor using any available tools.
- 2 Remove the screws, disconnect the wires and take out the light source.

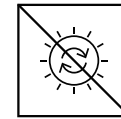

The light source is not replaceable.



This luminaire contains a light source with the energy class F.