

CHARGING AND OPERATION:

STEP 1. Charge the solar light by placing it under direct sunlight for at least 8 hours.

STEP 2. Push the switch button down and the solar light will automatically charge under direct sunlight during the day time and illuminate at night.

NOTE: In order to verify that the light is on or not, cover the solar panel with your hand and light will turn on automatically.

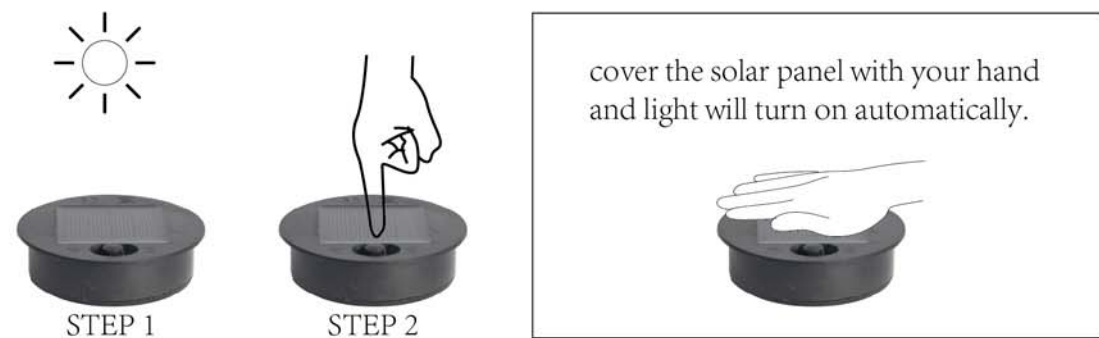

Battery replacement

- 1) Loosen 3 screws as above, and take down the plastic cover.
- 2) Put 1pcs AAA 300MAH NI-MH battery replace old one.
- 3) Put plastic cover back and tighten 3 screws.



48072