

# CHARGING AND OPERATION:

STEP 1. unpack 1pcs metal stick,and screw it into nut on metal round base.

STEP 2. screw rest 2pcs metal sticks

STEP 3. put cord plug into solar panel hole.

STEP 4. Push the switch button down and the solar light will automatically charge under direct sunlight during the day time and illuminate at night.

STEP 5. screw the light into top stick.



NOTE: In order to verify that the light is on or not, cover the solar panel with your hand and light will turn on automatically.

Please allow the battery to charge at least 8-12 hours before first use.It can light 6-8 hours.

## Battery replacement

- 1) Loosen 2 screws,take down square battery house
- 2) Loosen another 2pcs screws at square battery house, and put 1pcs new 18650 3.7v 1200mah li-ion battery
- 3) Put all plastic parts on and tighten all screws

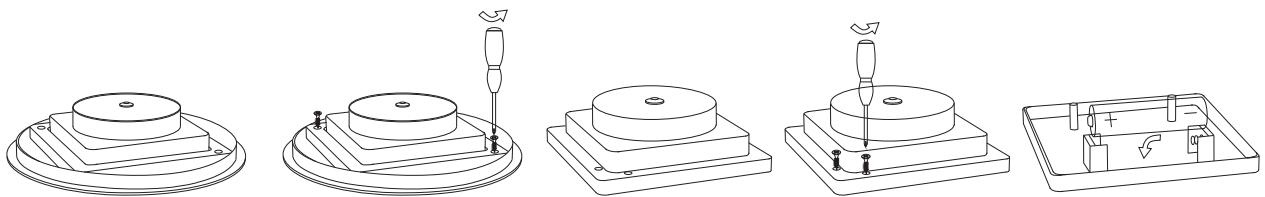

**48179**