

# FLOS

F1490009 Glass

## Mini Button

Designed by Piero Lissoni, 2005



Halogen - 25W

Wall or ceiling fixture providing diffused lighting suitable for indoor and outdoor use. Silicone elastomer dust and waterproof seal. Die-cast aluminum lamp body and wall fitting. Diffuser available in opaline glass or polycarbonate (IP44).

Are you a professional and your project needs consulting and support?

[BOOK AN APPOINTMENT](#)

### Main specifications

EAN	8059607015179
Mounting	Ceiling and wall surface
Environments	Indoor Outdoor wet location
Light Source Type	Bulb
Lamp category	Halogen
Lamp holders	G9
Iicos	HSGS
Number of heads	1
Power (W)	25

### Physical

Colour	Glass
Length (mm)	140
Net weight (kg)	0.66
Package height (mm)	70
Package width (mm)	190
Package length (mm)	205
IP internal	44

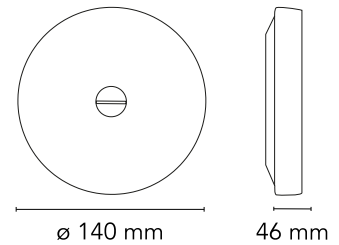

### Download

- [Mounting instructions](#)  PDF
- [Spare Parts](#)  PDF



## Schematic light drawing

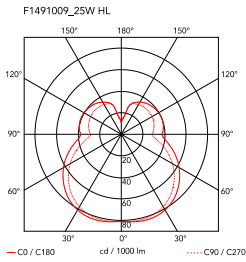

### Photometric

Light distribution	Roto symmetric
Extreme cut off	No

### Electrical

Insulation class	I
Frequency (Hz)	50/60
Main voltage (Vac)	220-250
LED voltage Vf (Vdc)	null
Dimmable	Yes
Dimming interface	Remote Dimmable (Dimmer Not Included)
Batteries inside	No

## Bulbs

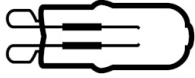

NOT INCLUDED

RF26520

LED Lamp 2W 240lm G9 220-240 2700K T13 Non Dimmable

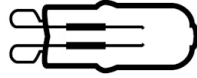

NOT INCLUDED

RF36378

LED BiPin Lamp G9 3,2W 2700K Dimmable

## Spare Parts

- |     |                         |           |
|-----|-------------------------|-----------|
| 01. | G9 5600 lamp holder     | RF12818   |
| 02. | Glass diffuser assembly | RF1490109 |

**DOWNLOAD**

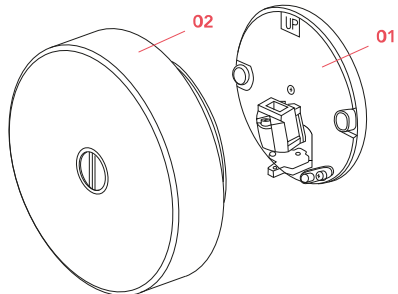



RF12818

G9 5600 lamp holder



RF1490109

Glass diffuser assembly